

STATE OF MONTANA  
DEPARTMENT OF HEALTH AND ENVIRONMENTAL SCIENCES  
CERTIFICATE OF SUBDIVISION PLAT APPROVAL  
(Section 76-4-101 through 76-4-131, MCA 1979)

WA 111111  
Ph. VI  
27/22-31-22

TO: County Clerk and Recorder  
Flathead County  
Kalispell, Montana

No. 15-93-L7-44  
436L

THIS IS TO CERTIFY THAT the plans and supplemental information relating to the subdivision known as **Lion Mountain Phase VI**

A subdivision located in the NE $\frac{1}{4}$  of the NW $\frac{1}{4}$  and the NE $\frac{1}{4}$  of Section 27, and the SE $\frac{1}{4}$  of the SW $\frac{1}{4}$  and the SW $\frac{1}{4}$  of the SE $\frac{1}{4}$  of Section 22, Township 31 North, Range 22 West, P.M.M, Flathead County, MT

consisting of 21 lots have been reviewed by personnel of the Water Quality Bureau, and,

THAT the documents and data required by Section 76-4-101 through 76-4-131, MCA 1979 and the rules of the Department of Health and Environmental Sciences made and promulgated pursuant thereto have been submitted and found to be in compliance therewith, and,

THAT the approval of the Plat is made with the understanding that the following conditions shall be met:

THAT the lot sizes as indicated on the Plat to be filed with the county clerk and recorder will not be further altered without approval, and,

THAT each lot shall be used for one single-family dwelling, and,

THAT the public water supply system will consist of 2 wells and a 160,000 gallon reservoir and will be built in accordance with the approved plans and specifications, and,

THAT the individual sewage treatment systems on Lots 6, 13, 14, 16 and 18 will consist of septic tanks and subsurface drainfields of such size and description as will comply with Flathead County Septic System Regulations and Title 16, Chapter 16, Sub-Chapters 1, 3, and 6 ARM, and,

THAT the subsurface drainfields shall have an absorption area of sufficient size to provide 190 square feet per bedroom, and,

THAT the public on-site sewage treatment system serving Lots 1, 2, 3, 4, 5, 7, 8, 9, 10, 11, 12, 15, 17, 19, 20 and 21 shall consist of a septic tank effluent collection system, two dosed sand filter systems and two subsurface drainfield areas located on an easement area belonging to Lion Mountain Sewer System Association, and,

6413 on Community System. B 2/8/00

Page 2 of 3  
Lion Mountain Phase VI  
Flathead County  
E.S.#15-93-L7-44

THAT said public sewage treatment system will be monitored by the Lion Mountain Sewer System Association in accordance with the monitoring agreement to be filed with this document, and,

THAT shared water user's and sewage treatment system user's agreements have been prepared and shall be filed along with this Certificate of Subdivision Plat Approval, and,

THAT the bottom of any drainfield shall be at least four feet above the water table, and,

THAT no sewage treatment system shall be constructed within 100 feet of the maximum highwater level of a 100 year flood of any stream, lake, watercourse, or irrigation ditch, nor within 100 feet of any domestic water supply source, and,

THAT water supply and sewage treatment systems will be located as shown on the approved plans, and,

THAT plans for the proposed water and individual sewage treatment systems will be reviewed and approved by the Flathead County Health Department before construction is started, and,

THAT all sanitary facilities must be located as shown on the attached lot layout, and,

THAT the developer shall provide each purchaser of property with a copy of the Plat, approved location of water supply and sewage treatment systems as shown on the attached lot layout, and a copy of this document, and,

THAT instruments of transfer for this property shall contain reference to these conditions, and,

THAT departure from any criteria set forth in the approved plans and specifications and Title 16, Chapter 16, Sub-Chapters 1, 3, and 6 ARM when erecting a structure and appurtenant facilities in said subdivision without Department approval, is grounds for injunction by the Department of Health and Environmental Sciences.

Page 3 of 3  
Lion Mountain Phase VI , Flathead County  
E.S.#15-93-L7-44

YOU ARE REQUESTED to record this certificate by attaching it to the  
Plat filed in your office as required by law.

DATED this 14th day of September, 1993.

ROBERT J. ROBINSON  
DIRECTOR

By: Fraser  
for Dan L. Fraser, Chief  
Water Quality Bureau  
Environmental Sciences Division

Owner's Name: Tim Grattan, Lion Mountain, Inc.

STATE OF MONTANA  
DEPARTMENT OF HEALTH AND ENVIRONMENTAL SCIENCES  
CERTIFICATE OF SUBDIVISION PLAT APPROVAL  
(Section 76-4-101 through 76-4-131, MCA 1979)

Lion Mtn.  
Ph. V  
27/22-31-22

TO: County Clerk and Recorder  
Flathead County  
Kalispell, Montana

No. 15-93-L7-44  
436L

THIS IS TO CERTIFY THAT the plans and supplemental information relating to the subdivision known as **Lion Mountain Phase VI**

A subdivision located in the NE $\frac{1}{4}$  of the NW $\frac{1}{4}$  and the NE $\frac{1}{4}$  of Section 27, and the SE $\frac{1}{4}$  of the SW $\frac{1}{4}$  and the SW $\frac{1}{4}$  of the SE $\frac{1}{4}$  of Section 22, Township 31 North, Range 22 West, P.M.M, Flathead County, MT

consisting of 21 lots have been reviewed by personnel of the Water Quality Bureau, and,

THAT the documents and data required by Section 76-4-101 through 76-4-131, MCA 1979 and the rules of the Department of Health and Environmental Sciences made and promulgated pursuant thereto have been submitted and found to be in compliance therewith, and,

THAT the approval of the Plat is made with the understanding that the following conditions shall be met:

THAT the lot sizes as indicated on the Plat to be filed with the county clerk and recorder will not be further altered without approval, and,

THAT each lot shall be used for one single-family dwelling, and,

THAT the public water supply system will consist of 2 wells and a 160,000 gallon reservoir and will be built in accordance with the approved plans and specifications, and,

THAT the individual sewage treatment systems on Lots 6, 13, 14, 16 and 18 will consist of septic tanks and subsurface drainfields of such size and description as will comply with Flathead County Septic System Regulations and Title 16, Chapter 16, Sub-Chapters 1, 3, and 6 ARM, and,

THAT the subsurface drainfields shall have an absorption area of sufficient size to provide 190 square feet per bedroom, and,

THAT the public on-site sewage treatment system serving Lots 1, 2, 3, 4, 5, 7, 8, 9, 10, 11, 12, 15, 17, 19, 20 and 21 shall consist of a septic tank effluent collection system, two dosed sand filter systems and two subsurface drainfield areas located on an easement area belonging to Lion Mountain Sewer System Association, and,

64/3 on Community  
Sewer System  
A 2/8/22

THAT said public sewage treatment system will be monitored by the Lion Mountain Sewer System Association in accordance with the monitoring agreement to be filed with this document, and,

THAT shared water user's and sewage treatment system user's agreements have been prepared and shall be filed along with this Certificate of Subdivision Plat Approval, and,

THAT the bottom of any drainfield shall be at least four feet above the water table, and,

THAT no sewage treatment system shall be constructed within 100 feet of the maximum highwater level of a 100 year flood of any stream, lake, watercourse, or irrigation ditch, nor within 100 feet of any domestic water supply source, and,

THAT water supply and sewage treatment systems will be located as shown on the approved plans, and,

THAT plans for the proposed water and individual sewage treatment systems will be reviewed and approved by the Flathead County Health Department before construction is started, and,

THAT all sanitary facilities must be located as shown on the attached lot layout, and,

THAT the developer shall provide each purchaser of property with a copy of the Plat, approved location of water supply and sewage treatment systems as shown on the attached lot layout, and a copy of this document, and,

THAT instruments of transfer for this property shall contain reference to these conditions, and,

THAT departure from any criteria set forth in the approved plans and specifications and Title 16, Chapter 16, Sub-Chapters 1, 3, and 6 ARM when erecting a structure and appurtenant facilities in said subdivision without Department approval, is grounds for injunction by the Department of Health and Environmental Sciences.

Page 3 of 3  
Lion Mountain Phase VI , Flathead County  
E.S.#15-93-L7-44

YOU ARE REQUESTED to record this certificate by attaching it to the  
Plat filed in your office as required by law.

DATED this 14th day of September, 1993.

ROBERT J. ROBINSON  
DIRECTOR

By: *Fraser*  
for Dan L. Fraser, Chief  
Water Quality Bureau  
Environmental Sciences Division

Owner's Name: Tim Grattan, Lion Mountain, Inc.

Lion mt. Sub #4

STATE OF MONTANA  
STATE DEPARTMENT OF HEALTH AND ENVIRONMENTAL SCIENCES  
CERTIFICATE OF SUBDIVISION PLAT APPROVAL  
(Section 69-5001 through 69-5009, R.C.M. 1947)

To: County Clerk and Recorder  
Flathead County  
Kalispell, Montana 59901

No. 15-76-K328  
E.S. 76/K104

THIS IS TO CERTIFY THAT the plans and supplemental information relating to the public water supply system and the individual sewage disposal system for the subdivision known as Lion Mountain Subdivision No. 4 located in Flathead County, Montana have been reviewed by personnel of the Subdivision Bureau, and,

THAT the documents and data required by Section 69-5001 through 69-5009, R.C.M. 1947 and the rules of the Department of Health and Environmental Sciences made and promulgated pursuant thereto have been submitted and found to be in compliance therewith, and,

THAT approval of the plat of said subdivision is made with the understanding that the following conditions shall be met:

THAT Lot 14 is to be a water supply facility site lot and Lot 14 shall not be used for residential purposes, and,

THAT the lot size(s) as indicated on the plat to be filed with the county clerk and recorder will not be further altered, and,

THAT the lot shall be used for a single family dwelling, and,

THAT the public water system will be provided by the Lion Mountain Homeowners Association, and will supply water to the lot, and,

THAT the individual sewage disposal system will consist of a septic tank and subsurface drainfield of such size and capacity as set forth in MAC 16-2.14(10)-S14340 and,

THAT each subsurface drainfield shall have an absorption area based on a maximum application rate of no more than 1.50 gallons per square foot per day, and,

THAT the bottom of the drainfield shall be at least four feet above the water table, and,

THAT the bottom of the drainfield shall be at least four feet above bedrock occurrences, and,

THAT plans for the proposed water and individual sewage systems will be reviewed and approved by the Flathead County Health Department before construction is started, and,

THAT the developer shall provide each purchaser of property with a copy of the Lion Mountain Subdivision #4 plat including a copy of this subdivision plat approval of Lion Mountain #4, and,

THAT instruments of transfer for this property shall contain reference to these conditions, and,

THAT departure from any criteria set forth in MAC 16-2.14(10)-S14340 when erecting a structure and appurtenant facilities in said subdivision is grounds for injunction by the Department of Health and Environmental Sciences.

YOU ARE REQUESTED TO RECORD THIS CERTIFICATE





Lion Mt Sub #3

STATE OF MONTANA  
STATE DEPARTMENT OF HEALTH AND ENVIRONMENTAL SCIENCES  
CERTIFICATE OF SUBDIVISION APPROVAL  
(Section 69-5001 to 69-5005, R.C.M., 1947)

TO: County Clerk & Recorder  
Flathead County  
Kalispell, Montana 59901

Re: Lion Mountain Subdivision  
#3  
No. 15-74-K135  
E.S. 74/X48

THIS IS TO CERTIFY THAT the plans and supplemental information relating to the water supply and sewage disposal systems for the subdivision known as Lion Mountain #3 presently in the process of county review prior to filing, located in Flathead County, Montana, have been reviewed by engineers of the Environmental Sciences Division, and,

THAT the documents and data required by Section 69-5001 to 69-5005, Revised Codes of Montana, 1947 and the rules and regulations of this Board made and promulgated pursuant thereto have been submitted and found to be in compliance therewith, and,

THAT approval of the plat of said subdivision is made with the understanding that the following conditions shall be met;

THAT the lot sizes as indicated on the plat filed with the County Clerk and Recorder will not further be altered, and,

THAT the community water system has been previously approved for the whole subdivision, and,

THAT the individual sewage disposal system shall consist of a septic tank and subsurface drainfield of such size and capacity as set forth in Regulation MAC 16-2.14 (10)S14340 and will be located as indicated on typical plot plan, and,

THAT the subsurface drainfield shall have a minimum absorption area of 85 square feet per bedroom, and,

THAT no sewage disposal system shall be constructed within 100 feet of any stream, lake or watercourse and a minimum of four feet of separation must be maintained between the bottom of the drain tile and the maximum high ground water elevations, and,

THAT the developer shall provide each purchaser of property with a copy of the typical lot layout and said purchaser shall locate water and/or sewage facilities in accordance therewith, and,

THAT instruments of transfer for this property shall contain reference to these conditions, and,

THAT plans for the proposed water and individual sewage systems will be reviewed and approved by the Flathead County Health Department before construction is started, and,

THAT departure from any criteria set forth in State Board of Health and Environmental Sciences Regulation MAC 16-2.14 (10)S14340 when erecting a structure and appurtenant facilities in said subdivision is grounds for injunction by the State Board of Health and Environmental Sciences.

NOW, THEREFORE, the subdivision plat, and plans and specifications of the plat, in accordance with the requirements of the State Board of Health and Environmental Sciences, are hereby approved.

STATE OF MONTANA  
STATE DEPARTMENT OF HEALTH AND ENVIRONMENTAL SCIENCES  
CERTIFICATE OF REMOVAL OF SANITARY RESTRICTIONS  
(Section 59-5001 to 69-5005, R.C.M., 1947)

TO: County Clerk and Recorder  
Flathead County  
Kalispell, Montana

Re: Lion Mountain No. 2  
~~XXXXXXXXXX~~  
E.S. 73-341

THIS IS TO CERTIFY THAT the plans and supplemental information relating to individual water supply system and individual sewage disposal system for the subdivision known as Lion Mountain Subdivision Number 2 as surveyed and platted and recorded in the Flathead County Courthouse located in Kalispell, Flathead County, Montana, have been reviewed by engineers of the Environmental Sciences Division, and,

THAT the documents and data required by Section 69-5001 to 69-5005, Revised Codes of Montana, 1947 and the rules and regulations of this Board made and promulgated pursuant thereto have been submitted and found to be in compliance therewith, and,

THAT the lot sizes as indicated on the plat filed with the county clerk and recorder will not be further altered, and,

THAT the water system will be operated by Lion Mountain Incorporated and will supply water to the lot, and,

THAT the individual sewage disposal system shall consist of a septic tank and subsurface drainfield of such size and capacity as set forth in Regulation MAC 16-2.14(10)-S14340 and will be located as indicated on typical plot plan, and,

THAT the subsurface drainfield shall have a minimum absorption area of 65 square feet per bedroom, and,

THAT no sewage disposal system shall be constructed within 100 feet of any stream, lake or watercourse and a minimum four feet of separation must be maintained between the bottom of the drain tile and the maximum high ground water elevations, and,

THAT plans for the proposed water and individual sewage systems will be reviewed and approved by the Flathead County Health Department before construction is started, and,

THAT departure from any criteria set forth in State Board of Health and Environmental Sciences Regulation MAC 16-2.14(10)-S14340 when erecting a structure and appurtenant facilities in said subdivision is grounds for injunction by the State Board of Health and Environmental Sciences.

NOW, THEREFORE, the sanitary restriction imposed by said Section 69-5001 to 69-5005, Revised Codes of Montana, 1947 upon said tract is hereby and herewith removed.

YOU ARE REQUESTED to record this removal of sanitary restriction by attaching the within certificate to the map or plat of said subdivision filed in your office as required by law.

DATED this 6th day of August, 1973.

FOR THE STATE DEPARTMENT OF HEALTH  
AND ENVIRONMENTAL SCIENCES

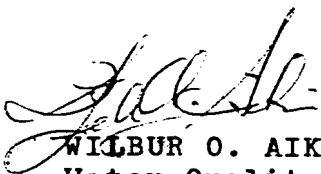

WILBUR O. AIKIN, P.E.  
Water Quality Bureau  
Environmental Sciences  
Division  
PCW/amh

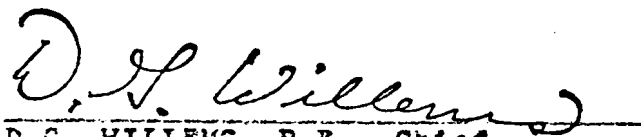

D.G. WILLEMS, P.E., Chief  
Water Quality Bureau  
Environmental Sciences Division

*Reserve Area  
Lion Mountain #2*

STATE OF MONTANA  
DEPARTMENT OF HEALTH AND ENVIRONMENTAL SCIENCES  
CERTIFICATE OF SANITARY RESTRICTION REMOVAL  
(Section 76-4-101 through 76-4-131, MCA, 1979)

To: Clerk and Recorder  
Flathead County  
Kalispell, MT

NO: 15-95-S356-1160

THIS IS TO CERTIFY THAT the plans and supplemental information relating to the subdivision known as the **RESERVE AREA, LION MOUNTAIN #2**; located in Northwest Quarter, of the Southwest Quarter, of Section 26, and the East half of the Northeast Quarter of Section 27, Government Lot 6, Section 22, Township 31 North, Range 22 West, P.M., M., Flathead County, Montana;

consisting of 1 parcel has been reviewed by personnel of the Water Quality Division, and,

THAT the documents and data required by Section 76-4-101 through 76-4-131, MCA 1979 and the rules of the Department of Health and Environmental Sciences made and promulgated pursuant thereto have been submitted and found to be in compliance therewith, and,

THAT approval of the PLAT is made with the understanding that the following conditions shall be met:

THAT the parcel size as indicated on the PLAT to be filed with the County Clerk and Recorder will not be further altered without approval, and,

THAT the lot shall be used for one single family dwelling, and,

THAT the water supply shall be connected to the Lion Mountain Community water supply, and,

THAT the individual sewage treatment system will consist of a septic tank and sub-surface drainfield of such size and description as will comply with Flathead County Septic System Regulations and Title 16, Chapter 16, Sub-Chapters 1, 3 & 6, and,

THAT the subsurface drainfield shall have an absorption area of sufficient size to provide 200 square feet per bedroom, and,

THAT the bottom of the drainfield shall be at least four feet above the water table, and,

15-95-S356-1160

Page 2 of 2

Flathead County

Lion Mountain Inc., % of Tim Gratton

THAT no sewage treatment system shall be constructed within 100 feet of the maximum high water level of a 100 year flood of any stream, lake, water course or irrigation ditch, north within 100 feet of any domestic water supply source, and,

THAT water supply and sewage treatment systems will be located as shown on the approved plans, and,

THAT plans for the proposed water and individual sewage treatment systems will be reviewed and approved by the Flathead County Health Department before construction is started, and,

THAT all sanitary facilities must be located as shown on the attached lot layout, and,

THAT the developer and/or owner of record shall provide the purchaser of the property with a copy of the PLAT, approved location of water supply and sewage treatment system as shown on the attached lot layout, and a copy of this document, and,

THAT instruments of transfer for this property shall contain reference to these conditions, and,

THAT departure from any criteria set forth in the approved plans and specifications and Title 16, Chapter 16, Sub-Chapters 1, 3 & 6 ARM when erecting a structure and appurtenant facilities in said subdivision without Department approval is grounds for injunction by the Department of Health and Environmental Sciences.

YOU ARE REQUESTED to record this certificate by attaching it to the PLAT filed in your office as required by law.

DATED this 17th day of May, 1995

Flathead County Health Officer

Robert J. Robinson, Director

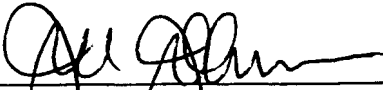
  
By: Jere Johnson, R.S.  
Environmental Health Specialist

  
By: Jim Melstad, P.E., Supervisor  
Subdivision Program  
Drinking Water Section  
Water Quality Division  
Montana D.H.E.S.

Co. No. 95/86

Owner's Name: Lion Mountain Inc., % Tim Gratton

Reserve Area Lion Mountain #2

Montana Department of Health  
and Environmental Sciences

APPROVED

Initials *CPC* Date *5/25/95*

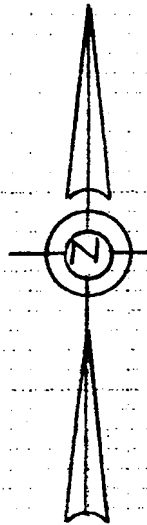
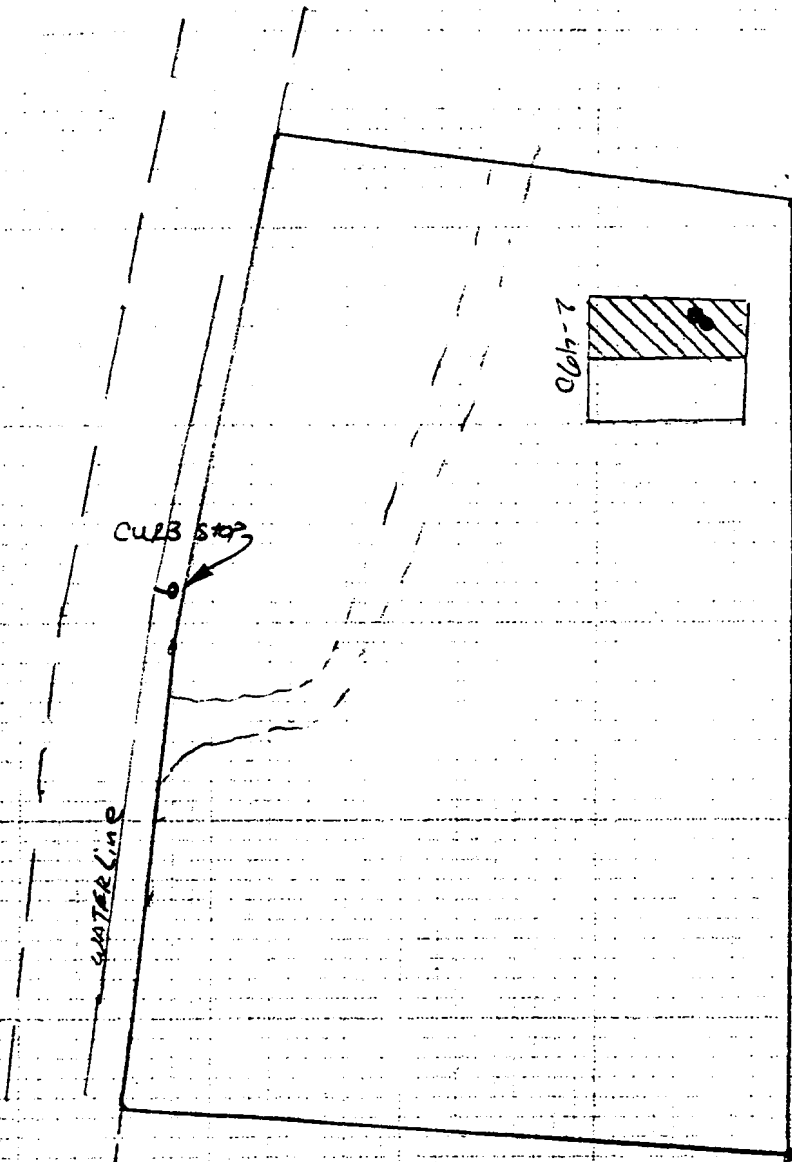





RECEIVED

MAY 19 1995

MONTANA  
DEPT. OF HEALTH & ENV. SCIENCES  
WATER QUALITY BUREAU

LOT LAYOUT  
FOR: LION MT INC  
BY: ECS  
DATE: 3-31-95  
SCALE: 1" = 100'

LEGEND

-  - PROPOSED DRAINFIELD
-  - 100% REPLACEMENT SITE
-  - TEST HOLE
-  - PERC TEST

STATE OF MONTANA  
STATE DEPARTMENT OF HEALTH AND ENVIRONMENTAL SCIENCES  
CERTIFICATE OF REMOVAL OF SANITARY RESTRICTIONS  
(Section 69-5001 to 69-5005, R.C.M., 1947)

TO: County Clerk and Recorder  
Flathead County  
Kalispell, Montana

RE: Lion Mountain #1 Subdivision  
~~No. 15-7-860~~  
E.S. 73/199.

THIS IS TO CERTIFY THAT the plans and supplemental information relating to individual water supply system and individual sewage disposal system for the subdivision known as Lion Mountain Number 1 as surveyed and platted and recorded in the Flathead County Courthouse located in Kalispell, Montana, have been reviewed by engineers of the Environmental Sciences Division, and,

THAT the documents and data required by Section 69-5001 to 69-5005, Revised Codes of Montana, 1947 and the rules and regulations of this Board made and promulgated pursuant thereto have been submitted and found to be in compliance therewith, and,

THAT the lot sizes as indicated on the plat filed with the county clerk and recorder will not be further altered, and,

THAT the water system will be operated by the Lion Mountain Homeowners Association and will supply water to the lots, and,

THAT the individual sewage disposal system shall consist of a septic tank and subsurface drainfield of such size and capacity as set forth in Regulation 51.300 and will be located as indicated on typical plot plan, and,

THAT each subsurface drainfield shall have a minimum absorption area of 120 square feet per bedroom, and,

THAT no sewage disposal system shall be constructed within 100 feet of any stream, lake or watercourse and a minimum four feet of separation must be maintained between the bottom of the drain tile and the maximum high ground water elevations, and,

THAT seepage pits are expressly prohibited, and,

THAT plans for the proposed water and individual sewage systems will be reviewed and approved by the Flathead County Health Department before construction is started, and,

THAT departure from any criteria set forth in State Board of Health and Environmental Sciences Regulation 51.300 when erecting a structure and appurtenant facilities in said subdivision is grounds for injunction by the State Board of Health and Environmental Sciences.

NOW, THEREFORE, the sanitary restriction imposed by said Section 69-5001 to 69-5005, Revised Codes of Montana, 1947 upon said tract is hereby and herewith removed.

YOU ARE REQUESTED to record this removal of sanitary restriction by attaching the within certificate to the map or plat of said subdivision filed in your office as required by law.

DATED this 14th day of May, 1973.

FOR THE STATE DEPARTMENT OF HEALTH  
AND ENVIRONMENTAL SCIENCES

Reviewed and Approved by: